

\\ctarlin02\Eng\Projects\2024\24-0055-PGD.dwg [C-2] Jul 07, 2025 2:43pm TRUBINO

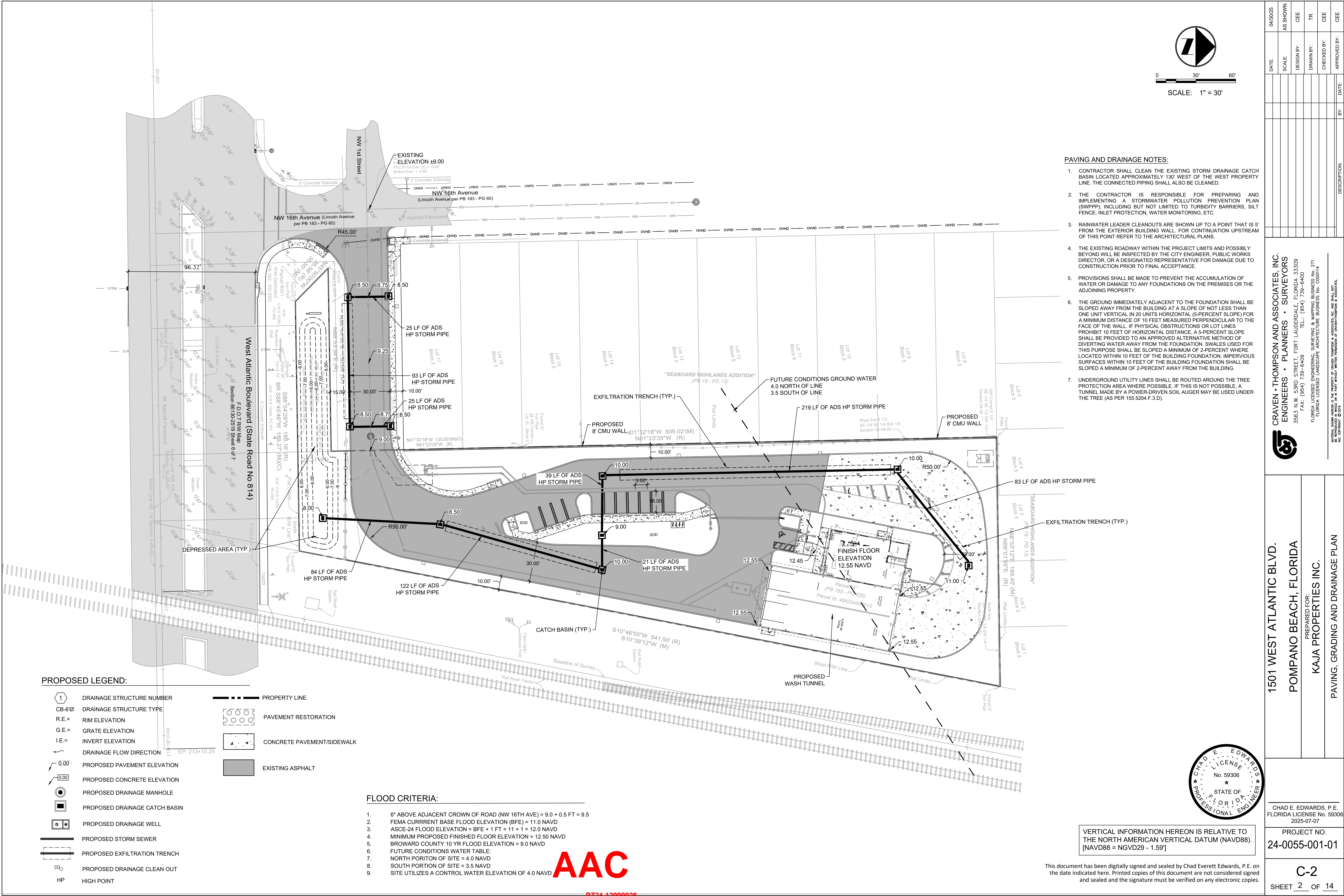

PAVING AND DRAINAGE NOTES:

- CONTRACTOR SHALL CLEAN THE EXISTING STORM DRAINAGE CATCH BASIN LOCATED APPROXIMATELY 130' WEST OF THE WEST PROPERTY LINE. THE CONNECTED PIPING SHALL ALSO BE CLEANED.
- THE CONTRACTOR IS RESPONSIBLE FOR PREPARING AND IMPLEMENTING A STORMWATER POLLUTION PREVENTION PLAN (SWPPP), INCLUDING BUT NOT LIMITED TO TURBIDITY BARRIERS, SILT FENCE, INLET PROTECTION, WATER MONITORING, ETC.
- RAINWATER LEADER CLEANOUTS ARE SHOWN UP TO A POINT THAT IS 5' FROM THE EXTERIOR BUILDING WALL. FOR CONTINUATION UPSTREAM OF THIS POINT REFER TO THE ARCHITECTURAL PLANS.
- THE EXISTING ROADWAY WITHIN THE PROJECT LIMITS AND POSSIBLY BEYOND WILL BE INSPECTED BY THE CITY ENGINEER, PUBLIC WORKS DIRECTOR, OR A DESIGNATED REPRESENTATIVE FOR DAMAGE DUE TO CONSTRUCTION PRIOR TO FINAL ACCEPTANCE.
- PROVISIONS SHALL BE MADE TO PREVENT THE ACCUMULATION OF WATER OR DAMAGE TO ANY FOUNDATIONS ON THE PREMISES OR THE ADJOINING PROPERTY.
- THE GROUND IMMEDIATELY ADJACENT TO THE FOUNDATION SHALL BE SLOPED AWAY FROM THE BUILDING AT A SLOPE OF NOT LESS THAN ONE UNIT VERTICAL IN 20 UNITS HORIZONTAL (5-PERCENT SLOPE) FOR A MINIMUM DISTANCE OF 10 FEET MEASURED PERPENDICULAR TO THE FACE OF THE WALL. IF PHYSICAL OBSTRUCTIONS OR LOT LINES PROHIBIT 10 FEET OF HORIZONTAL DISTANCE, A 5-PERCENT SLOPE SHALL BE PROVIDED TO AN APPROVED ALTERNATIVE METHOD OF DIVERTING WATER AWAY FROM THE FOUNDATION. SWALES USED FOR THIS PURPOSE SHALL BE SLOPED A MINIMUM OF 2-PERCENT WHERE LOCATED WITHIN 10 FEET OF THE BUILDING FOUNDATION. IMPERVIOUS SURFACES WITHIN 10 FEET OF THE BUILDING FOUNDATION SHALL BE SLOPED A MINIMUM OF 2-PERCENT AWAY FROM THE BUILDING.
- UNDERGROUND UTILITY LINES SHALL BE ROUTED AROUND THE TREE PROTECTION AREA WHERE POSSIBLE. IF THIS IS NOT POSSIBLE, A TUNNEL MADE BY A POWER-DRAINED SOIL AUGER MAY BE USED UNDER THE TREE (AS PER 155.5204.F.3.D).

PROPOSED LEGEND:

- | | | | |
|--|--------------------------------|--|----------------------------|
| | 1 DRAINAGE STRUCTURE NUMBER | | PROPERTY LINE |
| | CB-8'Ø DRAINAGE STRUCTURE TYPE | | PAVEMENT RESTORATION |
| | R.E.= RIM ELEVATION | | CONCRETE PAVEMENT/SIDEWALK |
| | G.E.= GRATE ELEVATION | | EXISTING ASPHALT |
| | I.E.= INVERT ELEVATION | | |
| | DRAINAGE FLOW DIRECTION | | |
| | PROPOSED PAVEMENT ELEVATION | | |
| | PROPOSED CONCRETE ELEVATION | | |
| | PROPOSED DRAINAGE MANHOLE | | |
| | PROPOSED DRAINAGE CATCH BASIN | | |
| | PROPOSED DRAINAGE WELL | | |
| | PROPOSED STORM SEWER | | |
| | PROPOSED EXFILTRATION TRENCH | | |
| | PROPOSED DRAINAGE CLEAN OUT | | |
| | HP HIGH POINT | | |

FLOOD CRITERIA:

- 6" ABOVE ADJACENT CROWN OF ROAD (NW 16TH AVE) = 9.0 + 0.5 FT = 9.5
- FEMA CURRENT BASE FLOOD ELEVATION (BFE) = 11.0 NAVD
- ASCE-24 FLOOD ELEVATION = BFE + 1 FT = 11 + 1 = 12.0 NAVD
- MINIMUM PROPOSED FINISHED FLOOR ELEVATION = 12.50 NAVD
- BROWARD COUNTY 10 YR FLOOD ELEVATION = 9.0 NAVD
- FUTURE CONDITIONS WATER TABLE:
- NORTH PORTION OF SITE = 4.0 NAVD
- SOUTH PORTION OF SITE = 3.5 NAVD
- SITE UTILIZES A CONTROL WATER ELEVATION OF 4.0 NAVD

AAC

PZ24-12000026

08.20.2025

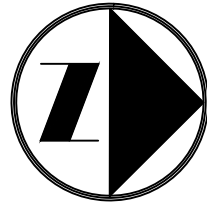

0 30' 60'

SCALE: 1" = 30'

CRAVEN · THOMPSON AND ASSOCIATES, INC.

ENGINEERS · PLANNERS · SURVEYORS

35653 N.W. 53RD STREET, FORT LAUDERDALE, FLORIDA 33309

FAX: (954) 739-6409 TEL: (954) 739-6400

FLORIDA LICENSED ENGINEERS, SURVEYORS & MAPPING BUSINESS NO. 271

FLORIDA LICENSED LANDSCAPE ARCHITECTURE BUSINESS NO. C00014

NATIONAL BOARD HEREON IS THE PROPERTY OF CRAVEN · THOMPSON & ASSOCIATES, INC. AND SHALL NOT BE REPRODUCED OR TRANSMITTED IN ANY FORM OR BY ANY MEANS, ELECTRONIC OR MECHANICAL, INCLUDING PHOTOCOPYING, RECORDING, OR BY ANY INFORMATION STORAGE AND RETRIEVAL SYSTEM, WITHOUT THE WRITTEN PERMISSION OF CRAVEN · THOMPSON & ASSOCIATES, INC. COPYRIGHT © 2015

1501 WEST ATLANTIC BLVD.

POMPANO BEACH, FLORIDA

PREPARED FOR:

KAJA PROPERTIES INC.

PAVING, GRADING AND DRAINAGE PLAN

CHAD E. EDWARDS, P.E.

FLORIDA LICENSE No. 59306

2025-07-07

PROJECT NO.

24-0055-001-01

C-2

SHEET

2

OF

14

VERTICAL INFORMATION HEREON IS RELATIVE TO THE NORTH AMERICAN VERTICAL DATUM (NAVD88). [NAVD88 = NGVD29 - 1.59']

This document has been digitally signed and sealed by Chad Everett Edwards, P.E. on the date indicated here. Printed copies of this document are not considered signed and sealed and the signature must be verified on any electronic copies.